

IMPORTANT: READ THE FOLLOWING INFORMATION BEFORE OPERATING YOUR:



23216

LOCK-ARM STABILIZING BAR

FOR USE ON TRAVEL TRAILERS AND 5TH WHEEL TRAILERS

INSTALLATION AND OPERATING INSTRUCTIONS

TOOLS NEEDED:

- 9/16" Socket
- 9/16" Open End Wrench
- 3/8" Nut Driver or Power Drill
- 3/16" Drill Bit

WARNING: BEFORE DRILLING HOLES INTO THE FRAME, BE SURE THERE ARE NO ITEMS THE DRILL BIT WILL DAMAGE INSIDE OR BEHIND FRAME (i.e.: electrical lines, braking or towing related items, holding or water tanks, etc.) ALSO CHECK WITH THE TRAILER MANUFACTURER OR SELLING DEALER TO MAKE SURE NO WARRANTIES ARE AFFECTED BY DRILLING INTO THE TRAILER FRAME.

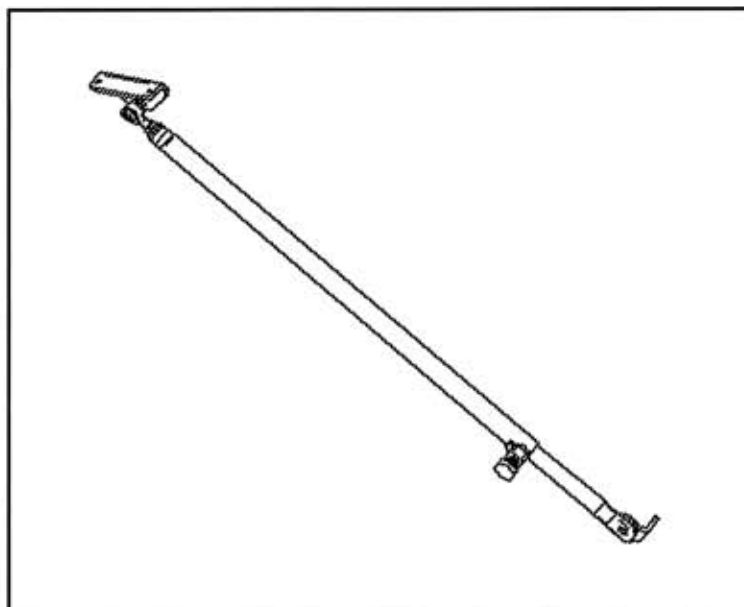

DETERMINING CORRECT MOUNTING LOCATION

Determine a location on the trailer frame to mount the frame bracket on the Lock-Arm. The area can be on the side of the frame (Figure 1) or the bottom of the frame (Figure 2) depending on the ability for the Lock-Arm to operate freely in the up and down direction. (One thing to consider when picking a mount location should be the vertical position the jack foot or pad will move up and down. If the jack is mounted at an angle to the frame, the frame bracket can be also mounted at a similar angle to align the Lock-Arm more evenly with the jack's operation.) The center of the frame bracket must mount at least 27" from the spot on the jack where the Lock-Arm will attach and should be also at least 4" x 1" in area size to allow the bracket to fit completely flat against the frame.

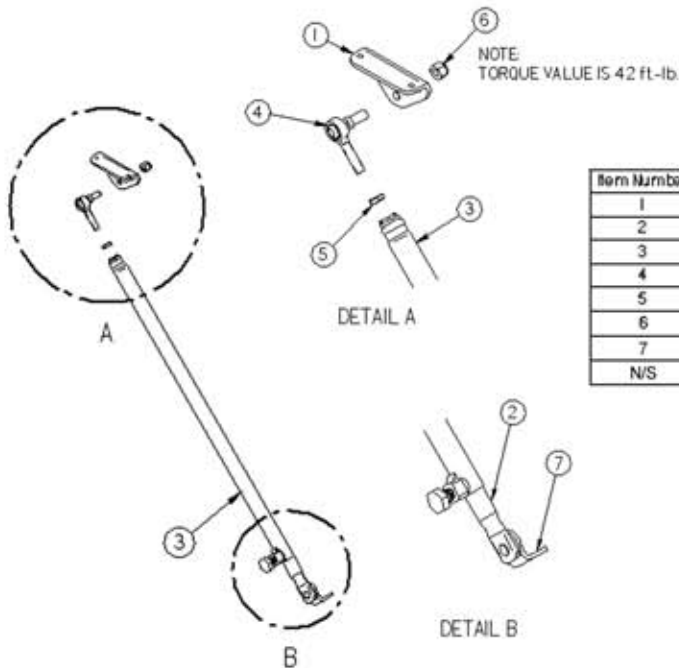

Figure 1



Figure 2

PARTS LIST



Item Number	Part Number	Part Description	Qty.
1	P852821	FRAME MOUNT BRACKET - LOCK ARM	1
2	P852823	INNER TUBE - LOCK ARM	1
3	P852822	OUTER TUBE - LOCK ARM	1
4	503137	ROD END, 3/8-24	1
5	503135	NUT, 3/8-24, HEX JAM	1
6	503136	NUT, 3/8-24, HEX NYLOCK	1
7	P852824	FOOT MOUNT BRACKET, INNER TUBE	1
N/S	852868	HARDWARE PACK	1

BOLT-ON INSTALLATION INSTRUCTIONS

STEP 1: Park and level your travel trailer or fifth-wheel trailer. Prevent wheels from rolling by using tire chocks.

STEP 2: After identifying the desired location on the frame; use the frame bracket as a template by marking the center of the hole that is closest to the jack location with a pencil or marker that can be easily seen. Once marked, you may pre-drill the hole using a 3/16" drill bit for easier mounting or you can also attach without pre-drilling using the included 1/4" self-tapping screw (3/8" nut driver required) (See Figure 3 & 4). Loosely tighten this screw to secure the bracket in place. This will allow you to maneuver the frame bracket to the correct position against the frame once the foot mount bracket is mounted to the jack foot or pad in Step 4.

STEP 3: Determine a location to mount the foot mount bracket on the jack's foot, leg or pad. This location should be at the lower end of the leg closest to the spot where it touches the ground. If the jack doesn't have a foot pad already installed, most jacks will have a mounting hole that runs through the end of the leg for an optional foot pad. Use the included 3/8" bolt and nut to secure the foot mount bracket to the foot or leg (9/16" wrench or socket required) (See Figure 5 & 6). If the jack leg has a foot pad already attached, remove the pad's mounting bolt & nut and then reattach including the foot mount bracket using the same mounting bolt.

If there is not a hole on the jack leg to mount the foot mount bracket, you will need to drill a hole on the side of the foot or leg and use the included 3/8" bolt to attach the Lock-Arm's foot mount bracket (3/8" drill bit required). Again, this hole should be at the lower end of the jack leg closest to the spot it touches the ground.

STEP 4: Once the foot mount bracket is secured tightly to the jack leg or foot pad, operate the jack up and down to make sure the Lock-Arm moves freely with the jack and does not bind or encounter any obstructions. If all of the clearances are okay, secure the frame bracket by tightening the screw that was installed on Step 3. Repeat step 3 to install the second screw in remaining hole of the frame bracket. **DO NOT OVER TIGHTEN THE SCREWS AS YOU CAN STRIP THE MOUNTING HOLES.**

STEP 5: Repeat steps 2 thru 4 on second jack to complete installation of Lock-Arm kit.

BOLT-ON INSTALLATION INSTRUCTIONS (CONTINUED)



Figure 3



Figure 4



Figure 5



Figure 6

OPERATION

STEP 1: Park your travel trailer or fifth-wheel trailer in desired camping location. Prevent wheels from rolling by using tire chocks.

STEP 2: Level and/or stabilize the trailer using installed jacks.

STEP 3: Once the trailer is level or stabilized, secure both Lock-Arms in the locked position by tightening the set bolt clockwise using a 3/4" jack crank handle (or 3/4" socket or wrench). This will help eliminate unwanted movement during trailer use.

STEP 4: When you are ready to store jacks for travel, loosen each set bolt counter-clockwise with a 3/4" jack crank handle (or 3/4" socket or wrench). This will disengage the Lock-Arm and allow you to retract the leveling or stabilizing jacks to the stored position. Note: you are not required to retighten the set bolt while the Lock-Arm is in the stored position as the bolt is designed not to loosen up and fall out of the Lock-Arm do to vibration during travel.

CAUTION: Do not operate jack (up or down) while set bolt is engaged or it could cause damage to Lock-Arm and trailer's jack.

ADDITIONAL LOCK-ARM APPLICATIONS

Looking to eliminate additional trailer movement?

Add additional BAL Lock-Arm Stabilizing Bars to your trailer's stabilizing and leveling jacks in the opposite direction for extra stabilization of your trailer. Fifth wheel owners: add the Lock-Arm Stabilizing Bars to your landing gear jacks to assist in eliminating the unwanted movement during use of your trailer.

OTHER FINE BAL PRODUCTS

DELUXE SCISSORS TIRE LOCKING CHOCK

- Locks tandem wheels by applying opposing force to tires
- Aids in trailer stabilizing, stops tire shift
- Extends from 2-1/2" to 10"
- Rust inhibitive coating
- Plated ratchet wrench with comfort bumper
- Lightweight, easy to store
- Patents pending



TONGUE TWISTER

- Eliminates trial and error hitch alignment
- Side to side or diagonal placement moves trailer any direction with pin-point accuracy
- Chrome plated ratchet wrench moves trailer with ease
- Rust inhibitive coating

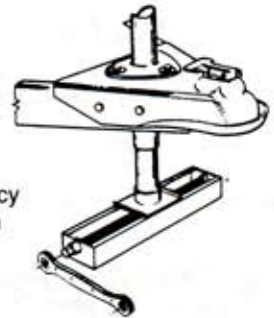

C-JACKS

- Offered in multiple sizes: 19", 22", 25", 28" and 31"
- Sold in pairs with speed wrench handle.
- Easy to install, will fit most trailers front or rear.
- Optional Power-Pak motor kit available for pushbutton operation.



TIRE LOCKING CHOCKS

- Locks tandem wheels by applying opposing force to tires
- Prevents trailer from rolling
- Aids in trailer stabilizing, stops tire shift

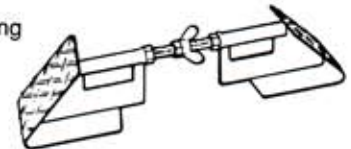

LEVELING SCISSOR JACKS

- Levels and stabilizes
- Two sizes (24" & 30") fit all RV's, front or rear
- Easy to operate
- Up to 7500 lbs. lifting capacity per jack
- Heavy duty, all steel construction
- Rust inhibitive coating

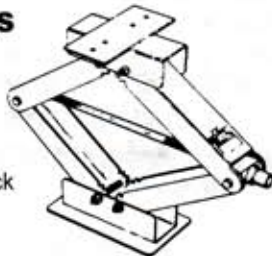

STABILIZER BASE PADS

- 7-1/4" diameter provides a firm footing on loose ground
- Easy to install, all hardware supplied
- Rubber sleeve prevents rattle during travel



BAL
RV PRODUCTS GROUP

For information or parts contact: BAL RV PRODUCTS GROUP, A Division of Norco Industries Inc.
365 W. Victoria St., Compton, CA 90220, (310) 639-4000

A DIVISION OF  NORCO INDUSTRIES, INC.